



Dear Customer, thank you for your trust and for purchasing this Wunderlich product.

This installation guide will assist you in the safe and proper installation of your product.

Important Note

Please read this guide completely before starting the installation.

Support

If you have any questions during the installation, please contact our support before beginning the work:

Tel.: +49 2641-3082-240

E-Mail: support@wunderlich.de

We wish you much enjoyment with your Wunderlich product and always a safe ride.

Your #TeamWunderlich



#31431-00x



Footrest relocation

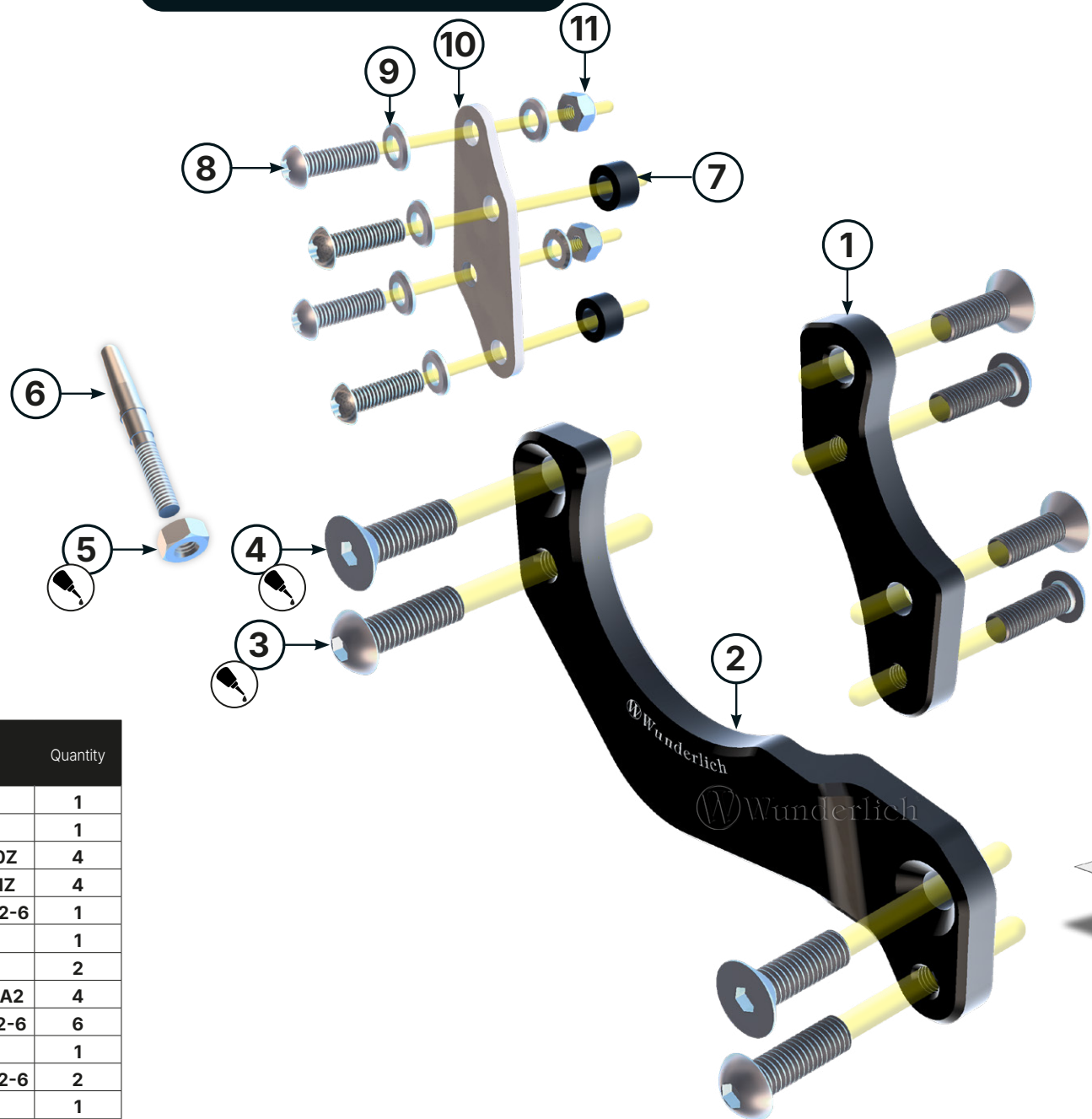
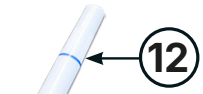

- Legend**
- Assembly tip
 - Attention
 - Enlargement
 - Assembly paste
 - Screw
 - Screw lock
 - Torque
 - Cleaner

#	Component	Quantity	
The colours of the illustrations are for illustrative purposes only.			
1	Relocation of footrest left side		1
2	Relocation of footrest right side		1
3	Lens head screw M8x25	7380Z	4
4	Countersunk screw M8x25	7991Z	4
5	Hexagon nut M6	934A2-6	1
6	Pressure pin		1
7	Sleeve ØD 13.0 - Ød 7.0 - h 7.0 mm		2
8	Lens head screw M6x20	7380A2	4
9	Washer M6	125A2-6	6
10	Relocation plate brake pump		1
11	Hexagon nut M6	985A2-6	2
12	Screw lock		1

#31431-00x

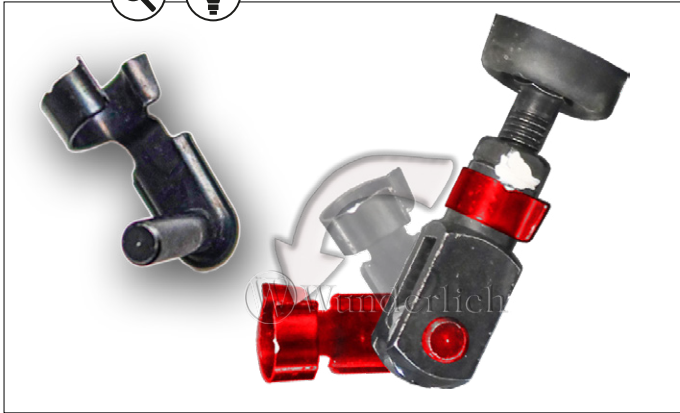

Loosen hexagonal nut in advance!

1

Wunderlich®

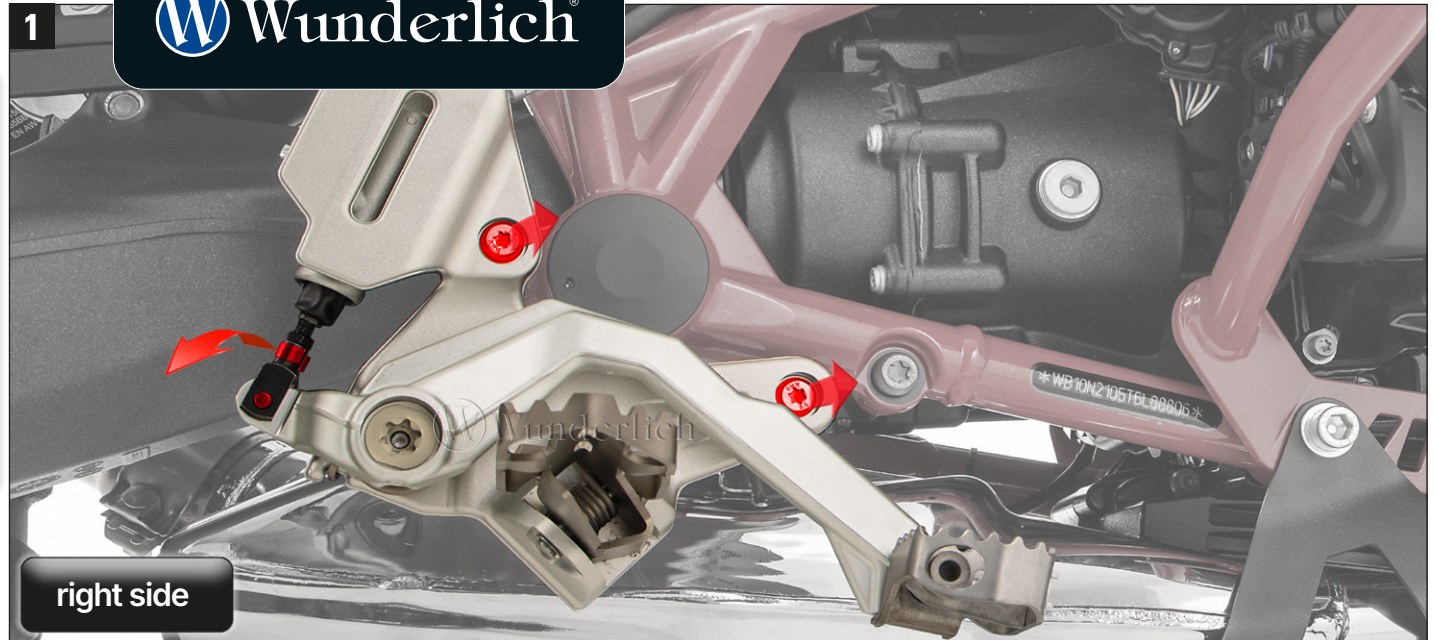

right side

2

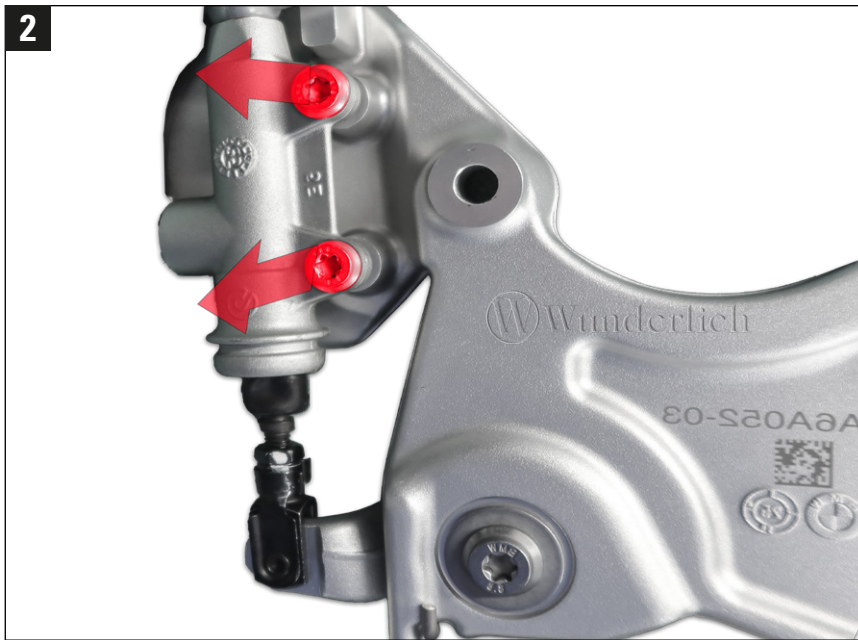

3

Replace pressure bolt!

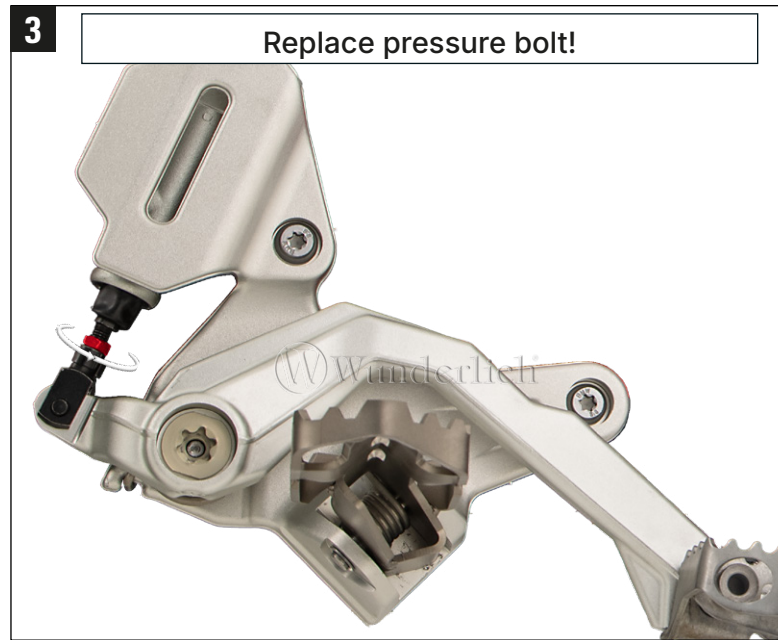

4



Locknut M6
5Nm



The assembly must only be carried out by trained and knowledgeable persons, or in a specialist workshop.
After assembly, check the rear wheel for free movement, if necessary adjust pressure bolt / brake lever (clearance / gap 1.3 mm)

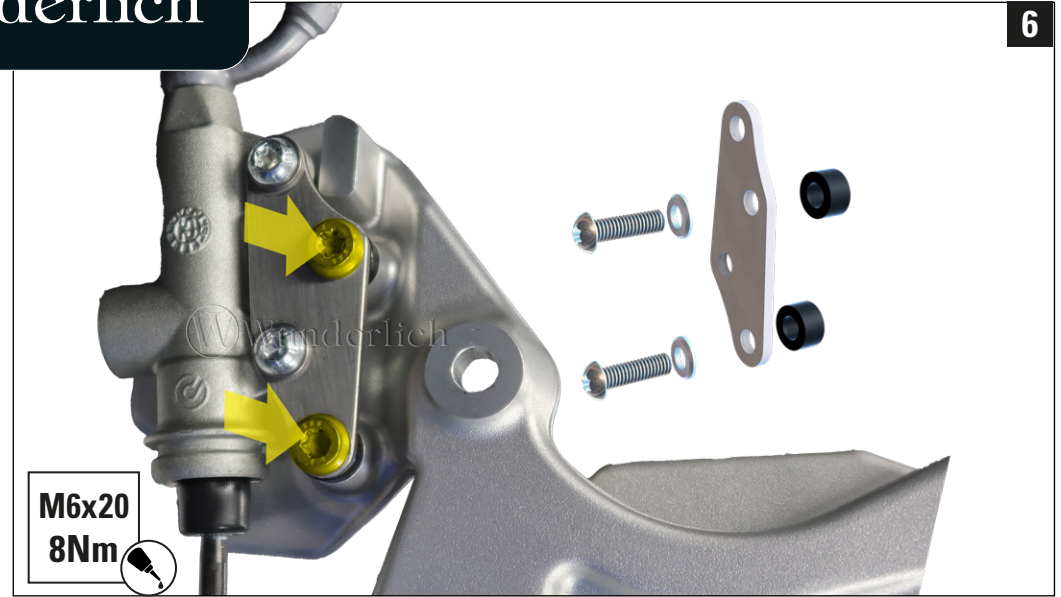

original screw or No. 3

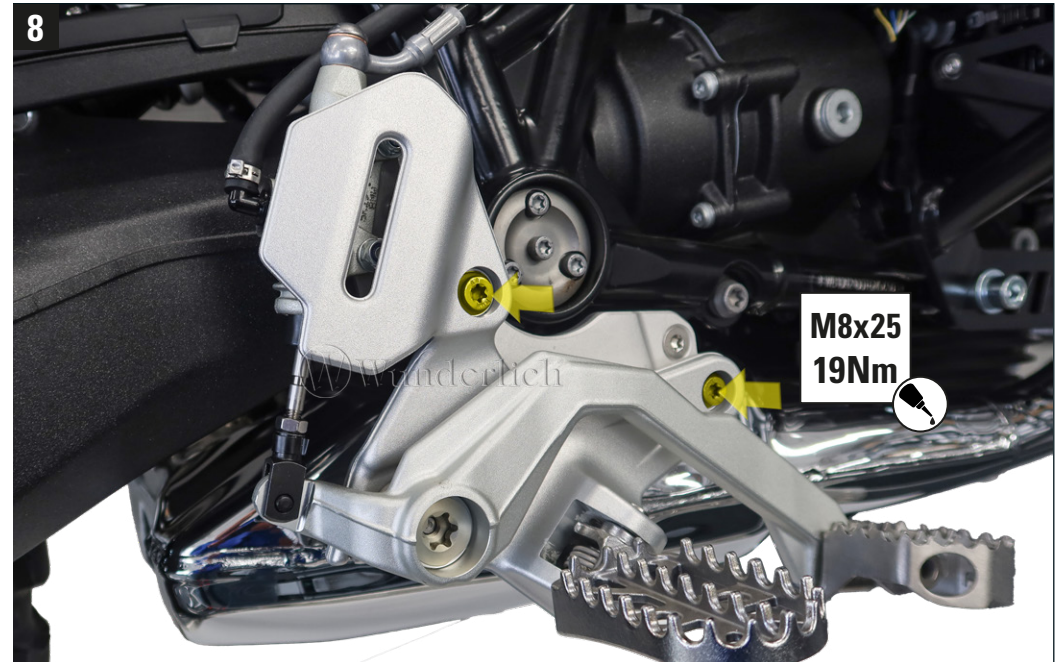
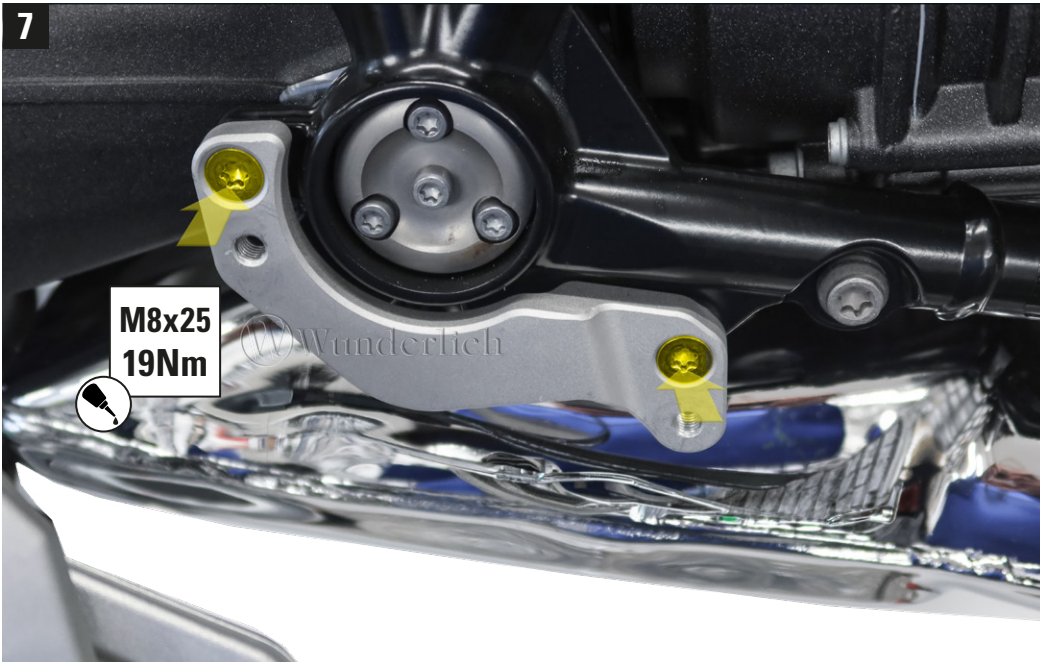

original screw or No. 8



Use original screw or No. 8 and adjust the gear-shifter