

Dear Customer, thank you for your trust and for purchasing this Wunderlich product.



This installation guide will assist you in the safe and proper installation of your product.

Important Note

Please read this guide completely before starting the installation.

Support

If you have any questions during the installation, please contact our support before beginning the work:

Tel.: +49 2641-3082-240

E-Mail: support@wunderlich.de

We wish you much enjoyment with your Wunderlich product and always a safe ride.

Your #TeamWunderlich

Handlebar protection bar

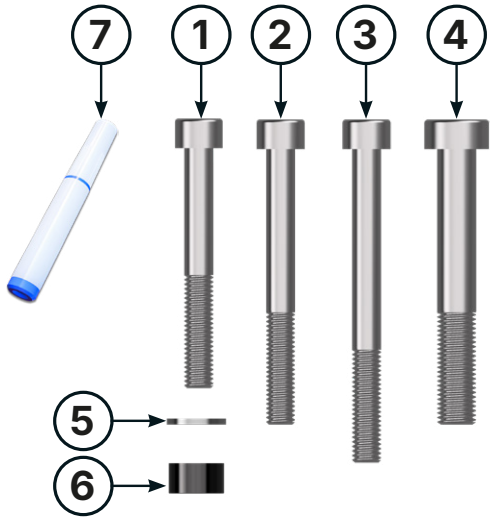

- Legend**
- Assembly tip
 - Attention
 - Enlargement
 - Cleaner
 - Screw
 - Threadlocker
 - Torque
 - Assembly paste

#	Component		Quantity
The colours of the illustrations are for illustrative purposes only.			
1	Socket head cap screw without handlebar riser	M8×55	4
2	Socket head cap screw with 20 mm handlebar riser	M8×75	4
3	Socket head cap screw with 40 mm handlebar riser	M8×95	4
4	Socket head cap screw	M10×75	2
5	Flat washer	M8	4
6	Aluminium spacer (black anodised) ØD 14.0 - 9.0 - 15.0 mm		4
7	Threadlocker		1

1



First loosely pre-assemble and align all attachments on the vehicle. Only then tighten the screws to the specified torque.
Check the steering for free movement, and adjust the instruments if necessary.

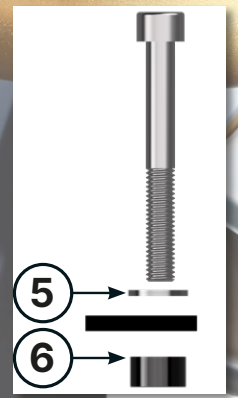
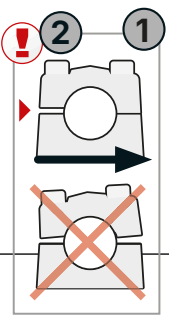
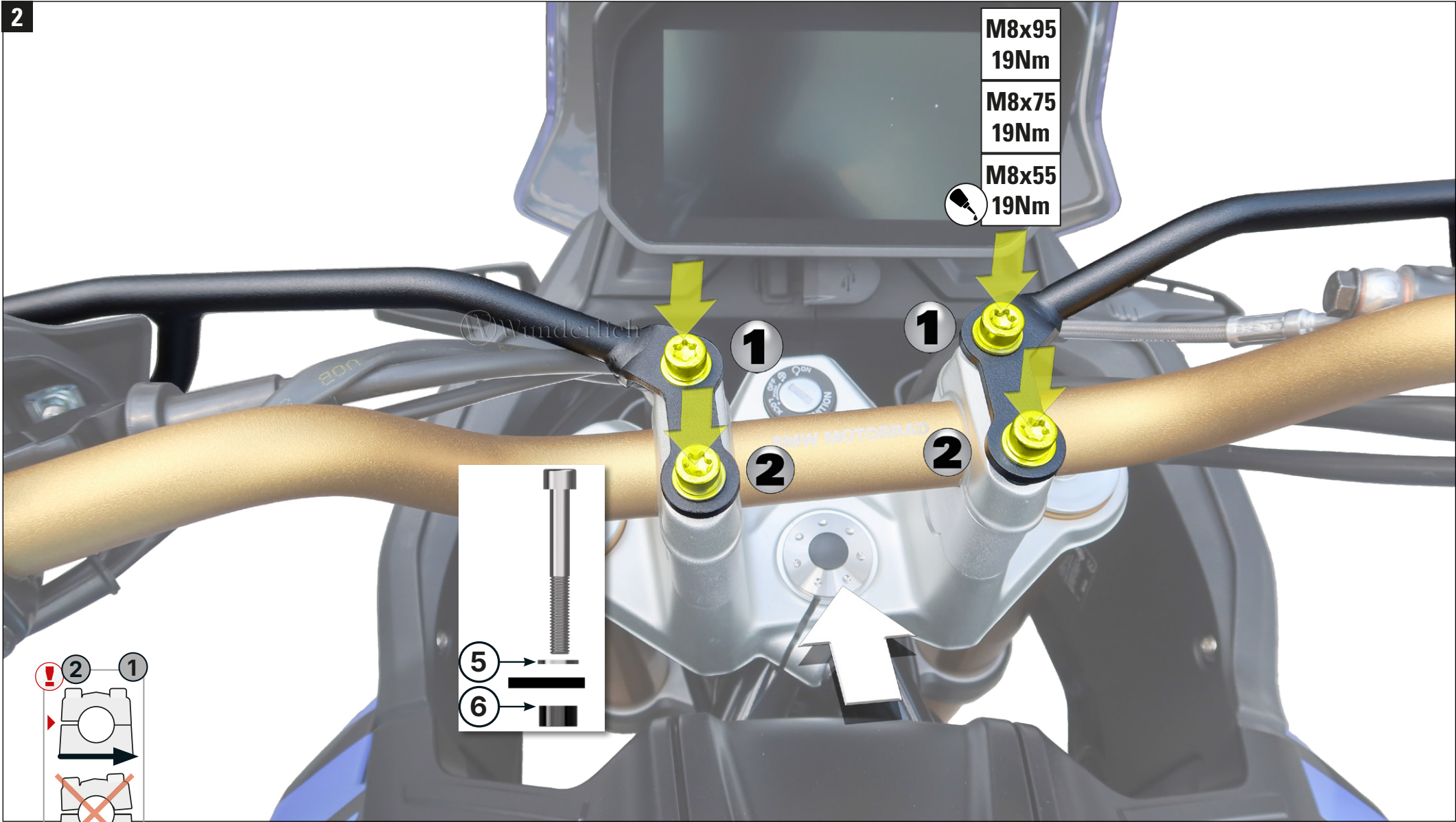

Tighten the screws in sequence 1 - 2. Mount the handle-bars in the zero position.

