

Tank guard



BMW F800 GS Adventure

Item - No.:
502.606 00 01 black

Assembling instructions

KRAUSER
MOTORRADGEPÄCKSYSTEME ■ BIKE BAGS

BMW F800 GS Adventure

Item - No.:
3005.033.202 black

The kit includes the following parts:

Quant	item no.	description
1x	700008267	tank guard left
1x	700008268	tank guard right
1x	700007958	holder top
2 set	150.720	alu adapter for tubes ø 25 mm (black)
1x	150.775	allen screw M6x80
5x	150.768	allen screw M6x45
2x	150.782	allen screw M8x20
8x	150.809	washer Ø6,4
4x	150.810	washer Ø8,4
2x	150.799	self lock nuts M6
2x	150.800	self lock nuts M8

Mountable only in connection with the original BMW engine guard

Preparing:

Dismantle plastic cover under
the front fender.

For this, unscrew the brake
line holder at the left side. ①



Control all screw connections after the assembling for tightness!
Please notice our enclosed service information.



Hepco & Becker GmbH
An der Steinmauer 6
D-66955 Pirmasens
Tel.: 0049 6331 - 1453 - 100
www.hepco-becker.de



Krauser GmbH
An der Steinmauer 6
D-66955 Pirmasens
Tel.: 0049 6331 - 1453 - 250
www.krauser.de

Tank guard



**BMW F800 GS
Adventure**

Item - No.:
502.606 00 01 black

Assembling instructions

KRAUSER
MOTORRADGEPÄCKSYSTEME ■ BIKE BAGS

**BMW F800 GS
Adventure**

Item - No.:
3005.033.202 black

Preparing: see page 1 **①**

Fastening of the holder:

under the instrument tray. Change the original screw with allen screw M6x80. Push the holder over the thread of these screw (under the fender) and fix it with washers and self lock nut M6. **②**

Another allen screw M6x45 crosswise fixes the holder, Secure with washers and self lock nut M6. Mount plastic cover again. Fix the brake line holder again. **③**

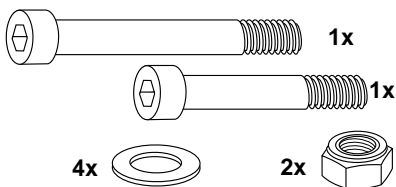

1

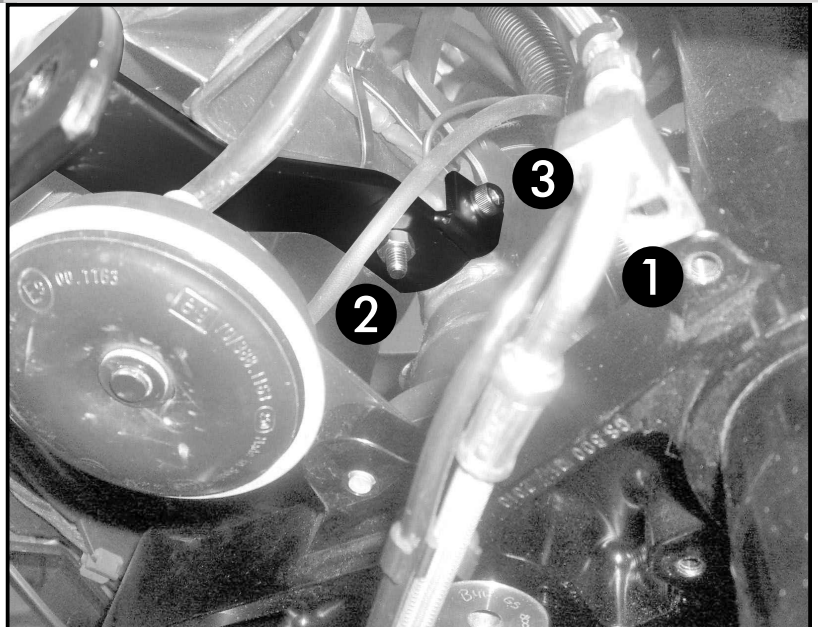

Attaching the tank guard front:

at the adapter with allen screw M8 x 20, self lock nut M8 and washers Ø8,4.

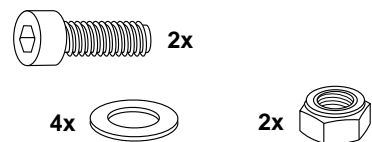

2

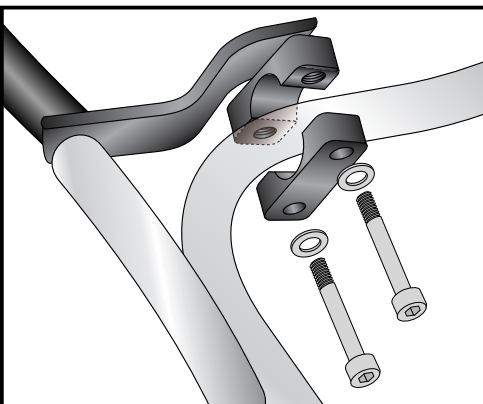
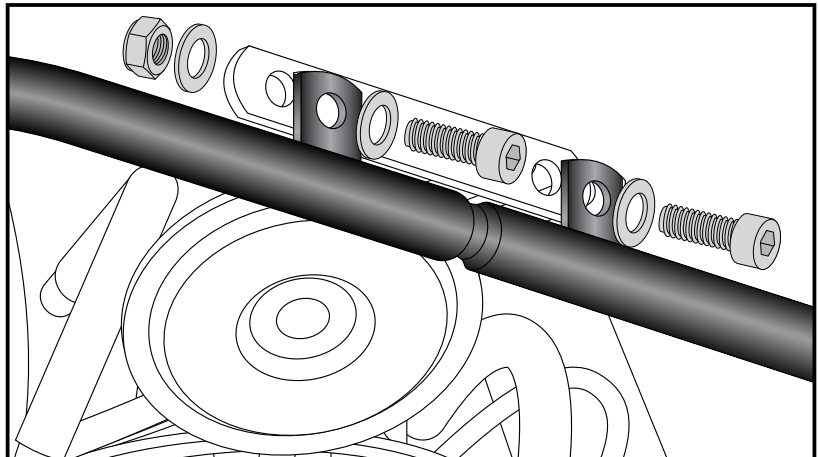

3

Fastening of the tank guard left and right bottom:

at the original engine guard with adapters for tubes, allen screws M6x45 and washers Ø6,4.

Align the tank guard to the same distance left and right before tightening.

