

VERKLEIDUNGSSCHEIBE

Windshield | Parabrezza | Pare-brise | Parabrisas

Art.-Nr: 42004-00x



Verkleidungsscheibe/Windshield

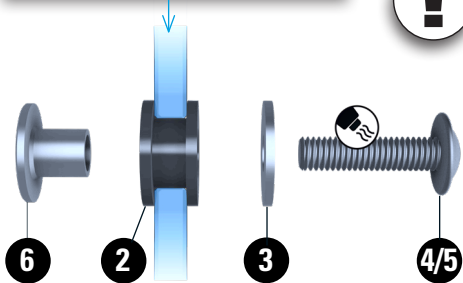

LEGENDE/KEY/FILE LÉGENDE

- Anbau Tipp**
Fitting tip
Astuce de montage
- Achtung**
Attention
Attention
- Vergrößerung**
Magnification
Grossissement
- Montagepaste**
Fitting lubricant
Lubrifiant de montage
- Schraube**
Screw
Vis
- Schraubensicherung**
Thread locking fluid
Freiniflets
- Drehmoment**
Torque
Torque
- Reiniger**
Cleaner
Nettoyant

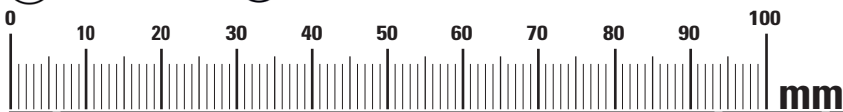

#	BEZEICHNUNG / DESCRIPTION	DE EN FR	Die Farben der Abbildungen dienen nur der Veranschaulichung. The colors are for illustrating purposes only. Les couleurs utilisées sont à titre indicatif seulement.	DIN	ISO	MENGE QUANTITY
1	Verkleidungsscheibe / windshield					1
2	Gummitülle / rubber grommet			7381SA2	7381SA2	6
3	U-Scheibe / washer M5			9021SA2	7093	6
4	Linseflanschschraube / lens head screw M5x25mm		1,5Nm	7381SA2	7381SA2	2
5	Linseflanschschraube / lens head screw M5x20mm		2,0Nm	7381SA2	7381SA2	4
6	Stufenhülse / grade sleeve					6
7	Scheibenhalter / bracket					1
8	Steckmutter / Plug-in nut					2
9	Montagepaste / Fitting lubricant					1

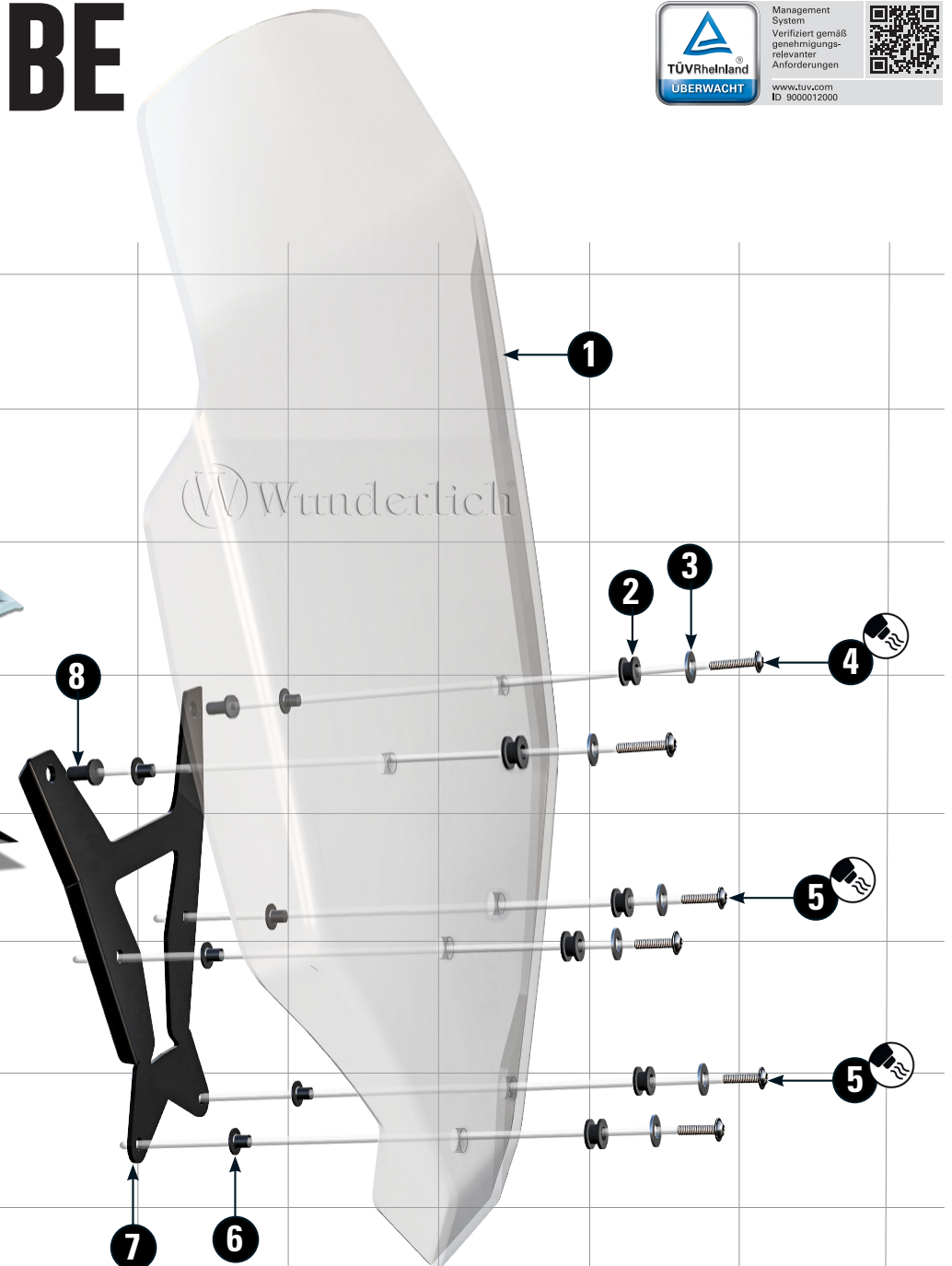
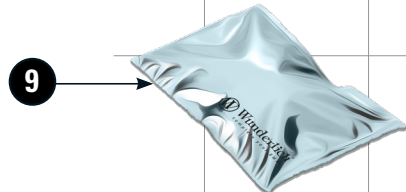

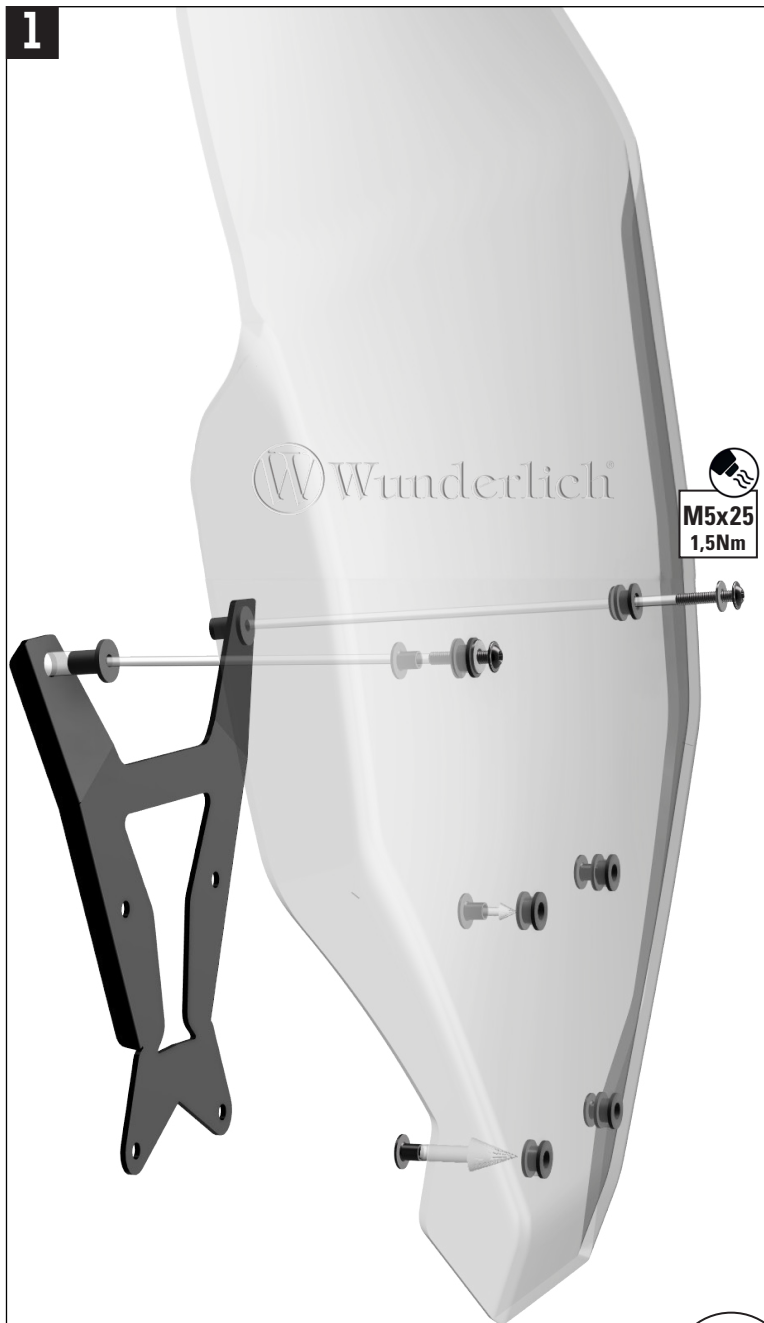
1

Verkleidungsscheibe und Halter wie gezeigt vormontieren.
Pre-assemble windshield and bracket as shown.
Pré-assembler le pare-brise et le support comme indiqué.

**2**