



Installation Instructions: R1200 GS Engine Protection Bar

Part Number 8160034

- 1 Center mounting bracket
- 2 6x18mm allen bolt
- 3 6x30mm allen bolt
- 4 6.4mm Ø washer
- 5 18 Ø x 13 Ø x 10mm spacer
- 6 6x12mm hex bolt
- 7 Left engine protection bar
- 8 10x55mm allen bolt
- 9 12x80mm allen bolt
- 10 10.5mm Ø washer
- 11 12.5mm Ø washer
- 12 25 Ø x 13 Ø x 25mm spacer
- 13 18 Ø x 11 Ø x 30mm spacer
- 14 Right engine protection bar
- 15 10x65mm allen bolt
- 16 25 Ø x 11 Ø x 40mm spacer

Congratulations on the purchase of these engine protection bars for your R1200 GS.

Simply compare the chart on the left with the images below to determine which hardware belongs where. The metric ruler below will assist you in determining hardware sizes. Begin by installing the center bracket and then attach the left and right sections of the bar.

When assembling, the use of a torque wrench is required. Please adhere to the standard torques as listed below. Install all fasteners loosely before tightening. Place a few drops of thread locking fluid (loctite) on all fasteners prior to final tightening.



Part to be fastened	NM	Ft. Lbs.
M 6 bolt with nut	12	9
M 8 bolt with nut	27	20
M 10 bolt with nut	40	29
M 12 bolt with nut	48	35

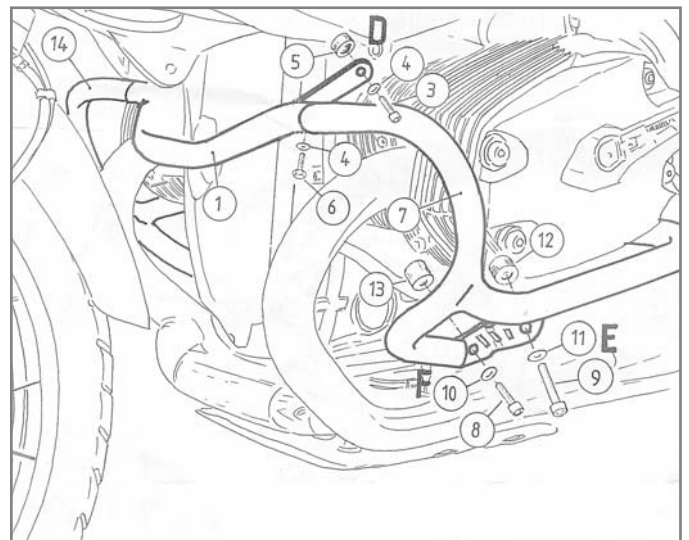
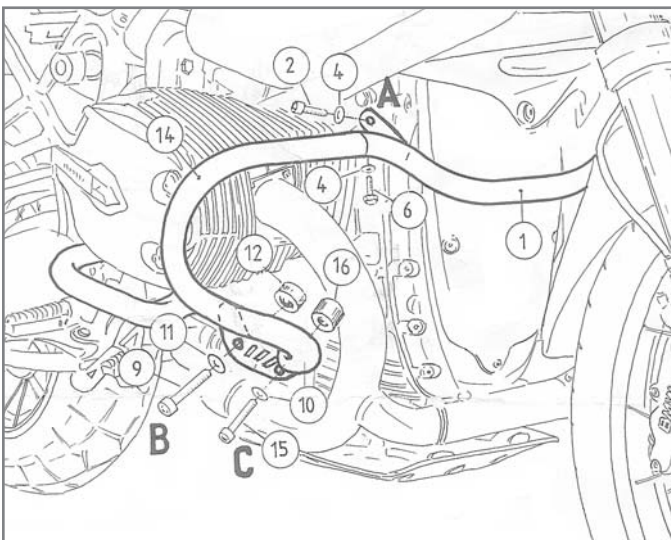

General note: Our fittings instructions are written to the best of our knowledge but specifications or details may change. If you have difficulties or have doubts with fitting this part please seek advice from your BMW dealer or workshop of your choice.

Please note that in some cases due to vehicle related tolerances beyond our control some products might need adjusting to fit. We cannot warranty parts fitting in those circumstances.