



SN.

Dr. Jekyll & Mr. Hyde®

THE EXHAUST

MANUAL : BMW® | EASYMOUNT | SMARTBOX 2

NEW IN THIS MANUAL:
- 2019 MODEL



R 1250 GS

2019 » Up

R 1250 GS

Easymount Smartbox 2

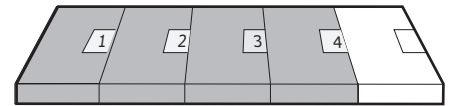

1 Assembly Kit

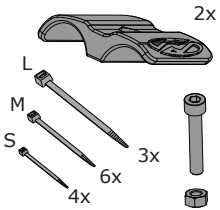

2 Smartbox 2

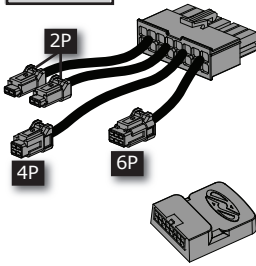

3 Mode Switch for Smartbox

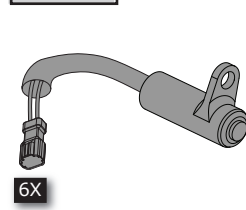

4 Smartbox Control Cable

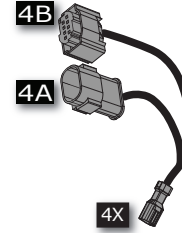

Exhaust/Cable /Servo System

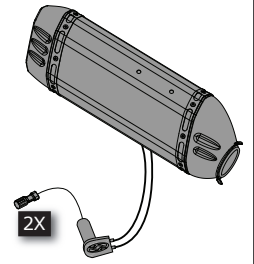

2

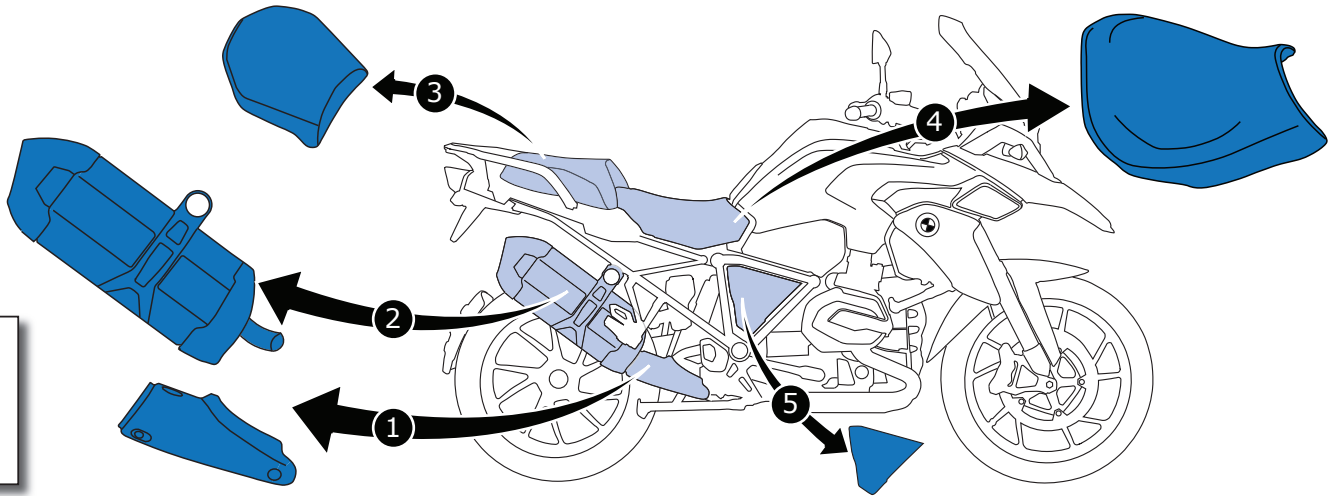

3

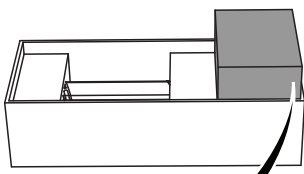

Items required



To mount the exhaust use the mountingset + manual

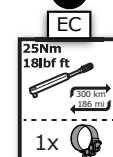
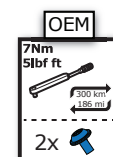
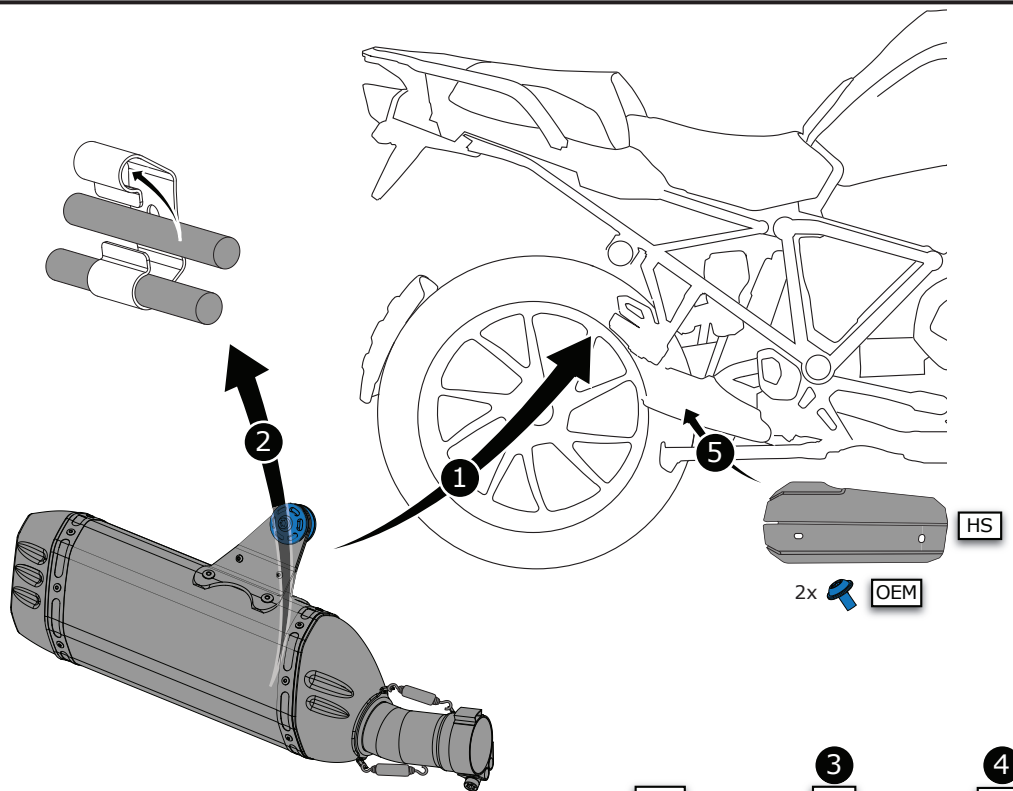
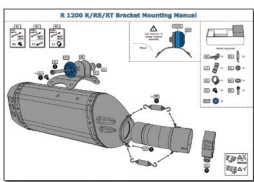

4

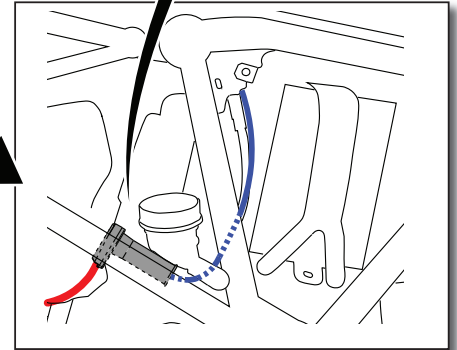
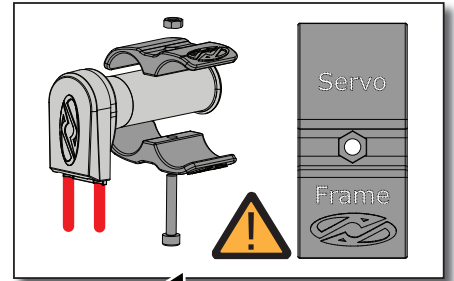
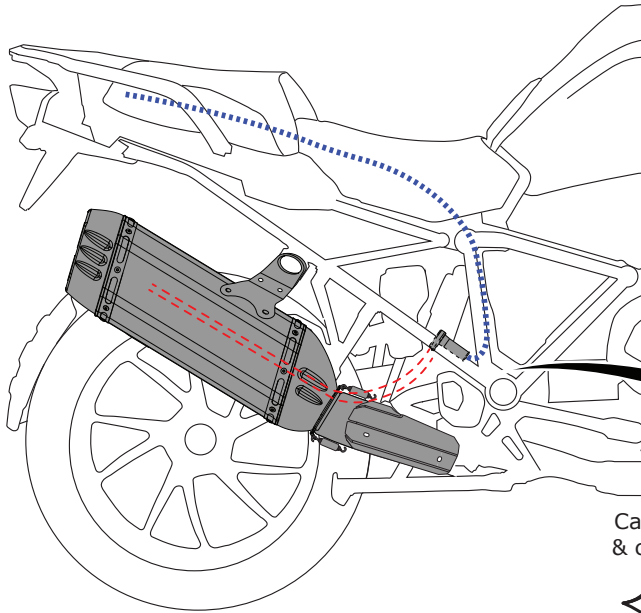
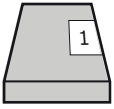

Cable routing & connecting:



5

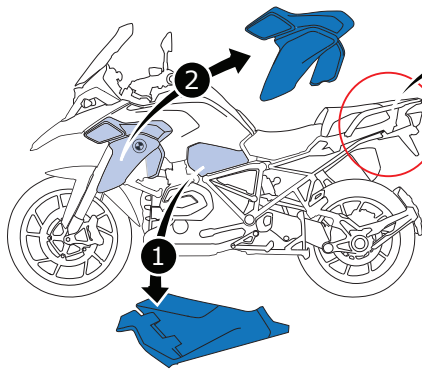

Current situation

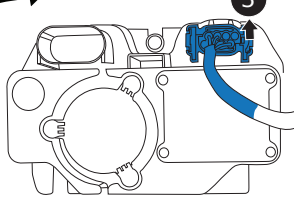

Connect control cable

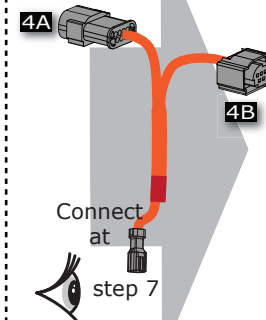

New situation

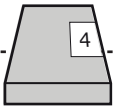
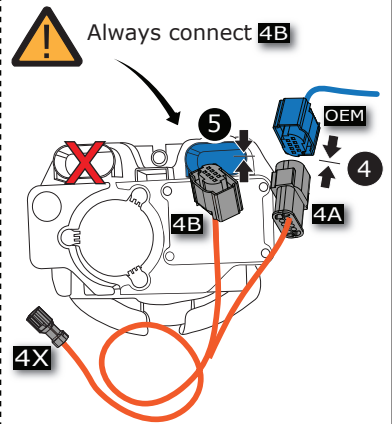

The alarm unit can be accessed in one of two manners:

Option 1: From below

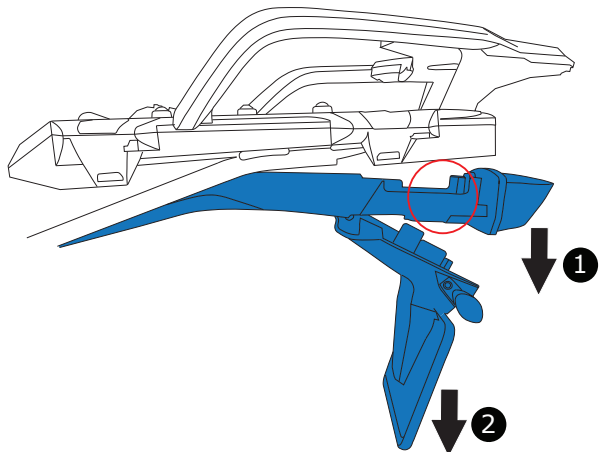

Option 2: From the top

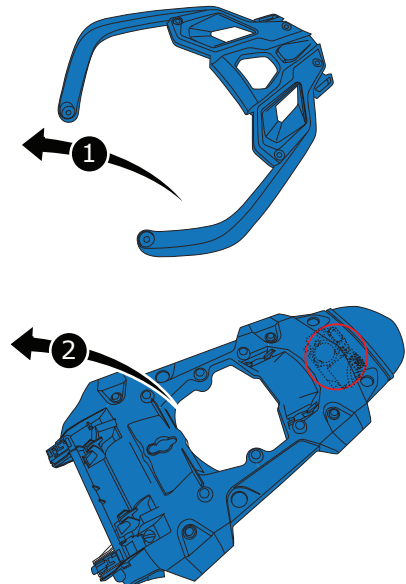

6

OEM
8Nm
6lbf ft
300 mm
196 mm
1x

Option 1

Or
Option 2
2 Nm
1,5 lbf ft
300 mm
196 mm
1x
B4

Cable routing & connecting:
step 7

7

2P + 2X

3
4P + 4X

4
6P + 6X

In reality all cables are black

Avoid Bending near the connector

Sufficient cable length for slack

8

Complete System Check!

R